

## A55

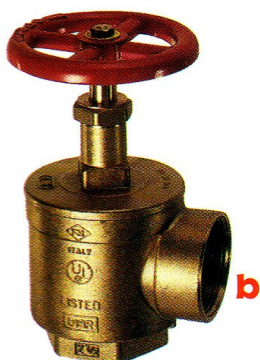

**a**

LISTED 618R



CE x 589

| <b>a</b>                      | <b>b</b>                      |
|-------------------------------|-------------------------------|
| 1 <sup>1</sup> / <sub>2</sub> | 1 <sup>1</sup> / <sub>2</sub> |
| 2 <sup>1</sup> / <sub>2</sub> | 2 <sup>1</sup> / <sub>2</sub> |

## ANGLE HOSE VALVE 300 lb. RATED

Used with a Fire Hose Rack Assembly, or as a Fire Dept. outlet connection.

### DOUBLE FEMALE

Standard equipment:  
Female NPT inlet and outlet forged brass valve.  
Red hand wheel.

#### Optional Finishes:

PB  
RC  
PC

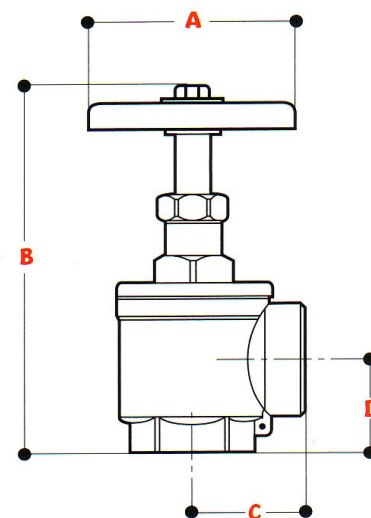

SPECIFY THREAD

|          | 1 <sup>1</sup> / <sub>2</sub> x 1 <sup>1</sup> / <sub>2</sub> | 2 <sup>1</sup> / <sub>2</sub> x 2 <sup>1</sup> / <sub>2</sub> |
|----------|---|---|
| <b>A</b> | 4 <sup>1</sup> / <sub>64</sub> "                              | 5 <sup>1</sup> / <sub>8</sub> "                               |
| <b>B</b> | 7 <sup>11</sup> / <sub>16</sub> "                             | 10 <sup>9</sup> / <sub>16</sub> "                             |
| <b>C</b> | 2 <sup>9</sup> / <sub>64</sub> "                              | 3 <sup>5</sup> / <sub>32</sub> "                              |
| <b>D</b> | 1 <sup>57</sup> / <sub>64</sub> "                             | 2 <sup>41</sup> / <sub>64</sub> "                             |

## A56



**a**

LISTED 618R



CE x 589

| <b>a</b>                      | <b>b</b>                      |
|-------------------------------|-------------------------------|
| 1 <sup>1</sup> / <sub>2</sub> | 1 <sup>1</sup> / <sub>2</sub> |
| 2 <sup>1</sup> / <sub>2</sub> | 2 <sup>1</sup> / <sub>2</sub> |

## ANGLE HOSE VALVE 300 lb. RATED

Used with a Fire Hose Rack Assembly, or as a Fire Dept. outlet connection.

### FEMALE x MALE

Standard equipment:  
Female NPT inlet x male hose thread outlet forged brass valve.  
Red hand wheel.

#### Optional Finishes:

PB  
RC  
PC

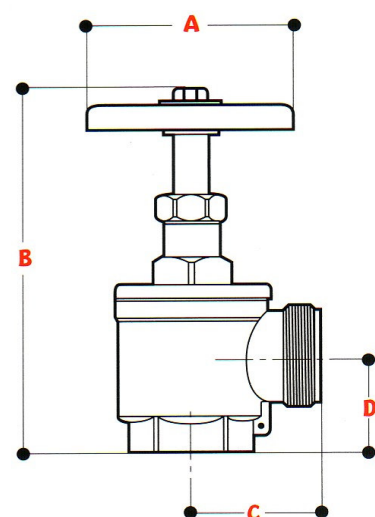

SPECIFY THREAD

|          | 1 <sup>1</sup> / <sub>2</sub> x 1 <sup>1</sup> / <sub>2</sub> | 2 <sup>1</sup> / <sub>2</sub> x 2 <sup>1</sup> / <sub>2</sub> |
|----------|---|---|
| <b>A</b> | 4 <sup>1</sup> / <sub>64</sub> "                              | 5 <sup>1</sup> / <sub>8</sub> "                               |
| <b>B</b> | 7 <sup>11</sup> / <sub>16</sub> "                             | 10 <sup>9</sup> / <sub>16</sub> "                             |
| <b>C</b> | 2 <sup>17</sup> / <sub>64</sub> "                             | 3 <sup>3</sup> / <sub>16</sub> "                              |
| <b>D</b> | 1 <sup>57</sup> / <sub>64</sub> "                             | 2 <sup>41</sup> / <sub>64</sub> "                             |